

explore



engage



discover



interact

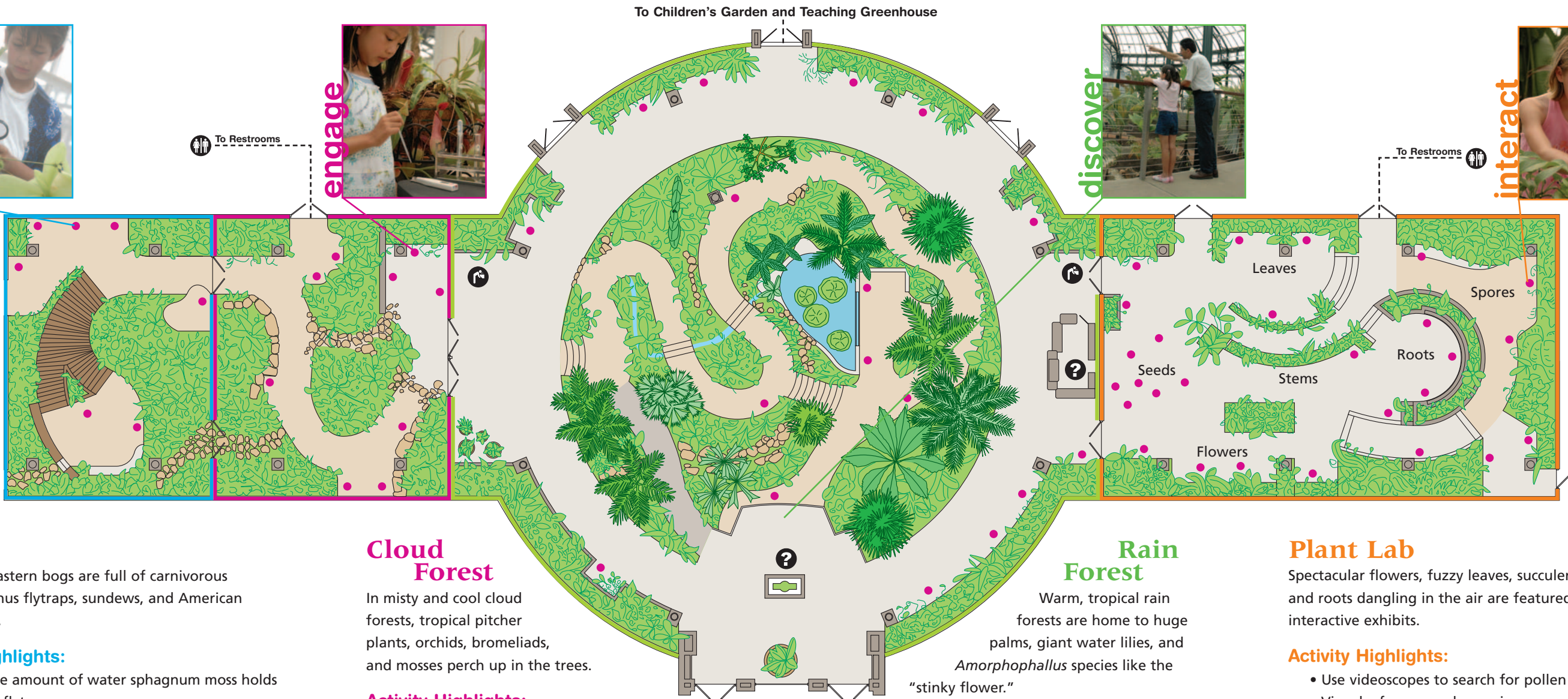

### Bog

Soggy southeastern bogs are full of carnivorous plants like Venus flytraps, sundews, and American pitcher plants.

#### Activity Highlights:

- Weigh the amount of water sphagnum moss holds
- Trigger a flytrap
- Examine the prey of a pitcher plant

### Cloud Forest

In misty and cool cloud forests, tropical pitcher plants, orchids, bromeliads, and mosses perch up in the trees.

#### Activity Highlights:

- Discover orchids that look like insects
- Look for life inside a bromeliad
- Measure the acidity of a pitcher plant's digestive juices

### Rain Forest

Warm, tropical rain forests are home to huge palms, giant water lilies, and *Amorphophallus* species like the "stinky flower."

#### Activity Highlights:

- Measure light levels in the forest canopy
- Identify plants used for foods
- Learn how giant water lilies are pollinated

### Plant Lab

Spectacular flowers, fuzzy leaves, succulent stems, and roots dangling in the air are featured in interactive exhibits.

#### Activity Highlights:

- Use videoscopes to search for pollen
- View leaf pores under a microscope
- Test how wind disperses seeds
- Measure the amount of sugar in flower nectars



### Legend

- Exhibit stations
- Drinking fountain
- Restrooms
- Information